

INSTALLATION

FLOATING FLOOR INSTALLATION

Subfloor properties

Karelia should be installed on a dry and level surface as a so-called floating floor. It is also possible to glue Karelia on to the subfloor.

Karelia hardwood flooring can be installed on concrete, particle board or a wooden floor, on top of plastic, linoleum or cork. The subfloor must be clean, clear and level to 3mm over 2 lineal meter. If the deviation exceeds 3 mm, the floor must first be leveled using either a suitable filler or board.

The relative humidity of a concrete floor without a moisture barrier must be less than 75%. To check the humidity, use a hygrometer.

A plastic sheet (PE) of 0.2 mm is recommended for use underneath and Tuxep Underlay (a sound-insulation material, see information on start page) if the floor is to be laid on top of concrete. An additional plastic sheet is not necessary for wooden subfloors and intermediate floors.

Before installation

Ideally the installation temperature should be higher than 18 °C. Keep the Karelia packs on a level surface, loosely placed in the room. Open the packages only as the installation work progresses.

How to choose the laying direction and the starting place

It is preferable to lay the boards in the direction of incoming light. However, if you lay Karelia on a wooden subfloor, it is recommended to lay them crosswise.

Start from a solid wall. First check with a cord that the wall is straight. A straight and solid starting line is crucial for successful installation. When necessary, draw a line matching the shape of the wall on the first boards and cut them into that shape.

Expansion allowance

Remember to leave a 10 mm gap between the wall and the board. Cover the gap with a skirting or cover strip. In larger floors, the gap should be 1.5 mm per meter crosswise.



Expansion joint

If the floor covers a large, continuous area of more than 8 meters in width (crosswise), an expansion joint should be inserted into the hardwood flooring. To make an expansion joint, do not apply glue on the board's long side, have a so-called dry joint instead. Alternatively, you can leave a gap of approximately 10 - 15 mm between the boards and cover it with a cover strip. If the boards are installed crosswise, cut them and leave a corresponding gap between them. The expansion joint should be placed, for example, into the doorway, a corner or other suitable place.

In some cases, even large areas can be covered without an expansion joint if there are no gaps or corners in the room.

Sound insulation

The Tuplex underlay inserted between the hardwood flooring and the subfloor insulates impact sounds, such as walking, excellently. In other than detached houses, the most important thing is proper sound insulation of the supporting ground structure.

For more detailed information about Tuplex please have a look at our starting page.

Underfloor Heating

Karelia and underfloor heating complement each other. Installation instructions are available from the manufacturers and salesmen of underfloor heating equipment.

When using underfloor heating, special attention must be paid to correct conditions: the humidity of the air indoors must be 40 - 60% and the maximum temperature of the floor surface +28 °C. The most even heat emission is obtained with a continuously-operated, water-circulation system. This does not raise the temperature too high, as may be the case with so-called storage systems. Continuously used, it also reduces the relative humidity of the air indoors. Wood insulates heat rather well, but in this case, the hardwood flooring gradually adapts to the conditions.

A couple of days before installation, the floor temperature should be lowered to approximately 18°C, and only returned to normal over 1 - 2 weeks after the installation.



The different species of wood do not have significant differences in thermal conductivity, but the heat is directed more quickly to the surface of a hardwood flooring in a stuck down rather than a floating installation.

Changes in the temperature also affect humidity. Beech, Jatoba and Maple are the most sensitive to changes in temperature and humidity. For this reason, these woods are not recommended for installation over underfloor heating.

For more detailed information how to install Karelia, see our Installer's guide below

PREPARATION

Preparation

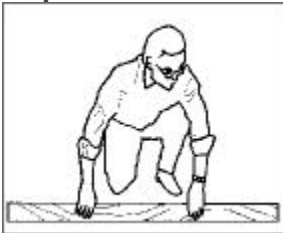

Start the installation by carefully reading the instructions. Clean the sub-floor and check that it is even.



If the sub-floor is more uneven than 3mm over 2 lineal meters, level by sanding or using filler. Concrete floors must be dry.

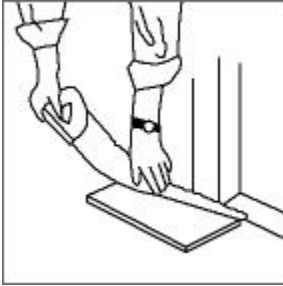

Cut the door frame so that the flooring has sufficient space to expand.

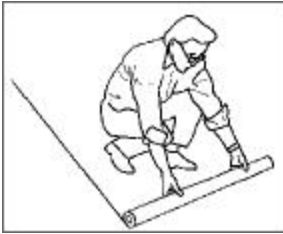

Spread a 10 Mil (0.2mm) plastic film on new concrete sub-floors as a moisture barrier and a sound insulation material such as Tuplex underlay.

INSTALLATION

Open a pack just prior to installation and one package at a time as you proceed with the installation. There is no need to sort the material as this is already done for you at the Karelia manufacturing plant. Install the product as it comes out of the pack. Inspect each board for possible defects.

Installation

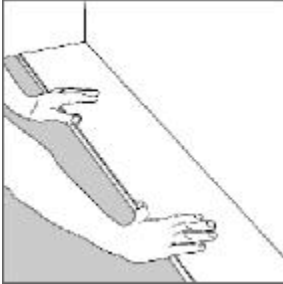

If the sub-floor is made of planks, lay the flooring crosswise to the sub floor. Place the first row of boards with the long side tongue against the wall. Expansion gap from the wall on the long side of the first board can be adjusted after three rows have been installed.



Install next board as shown in the picture.

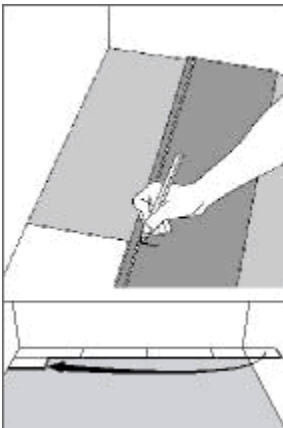

Cut the last board of the row to size and install it. Use the cut piece of the previous row to start the next row, min. length 30cm.



Press the first board of the next row at an angle against the board in the previous row and lay it flat. Check that the groove of the board of the previous row is free from sawdust and dirt. In case a gap remains between the boards, tap with your hand on the board joining board.

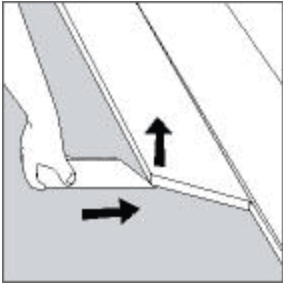

Place an installation wedge underneath the end of the installed board.

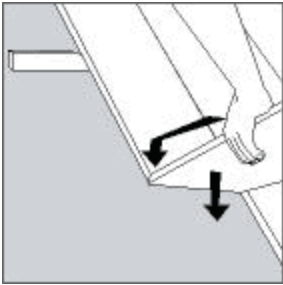

Install first the short end of the board into place at an angle and after that the long edge of the board.

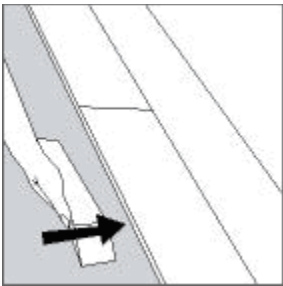

Remove the wedge and tap the board into place with the side of the wedge.

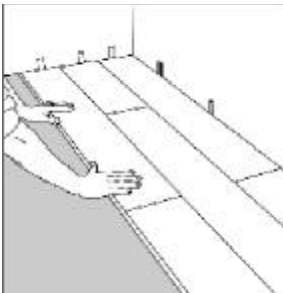

After three rows have been installed, the distance between the wood-flooring and the walls of min. 10mm can be adjusted by using wedges.

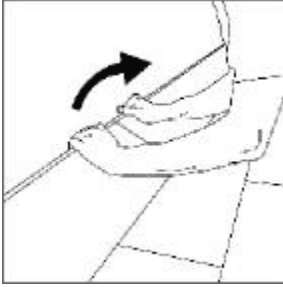

In case the wall is not straight, the shape of the wall can be drawn onto the boards of the first row by lifting the boards of the first row up and cut them to match the wall. Reinstall the boards from left to right.

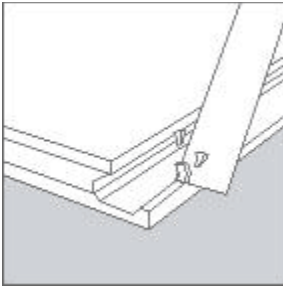

In case the last row of boards is to be installed underneath a door frame, cut away the locking edge, apply glue on the groove and install the board.

Remove the wedges and fasten the skirting boards, without pushing them too tightly against the floor.